



# QSW-308

## Quick Installation Guide

快速安裝手冊 빠른 설치 설명서 Guía de Instalación Rápida

クイックインストールガイド Hızlı Kurulum Kılavuzu

คู่มือการติดตั้งแบบเร็ว Gyors telepítési útmutató

Instrukcja szybkiej instalacji Průvodce rychlou in

Kurzinstallationsanleitung 快速安裝指南

Guida di installazione rapida Pika-asennusopas

Краткое руководство по установке

Snabbinstallationsguide

Guia de Instalação Rápida

Hurtiginstallasjonsveiledning

Hurt

P

S

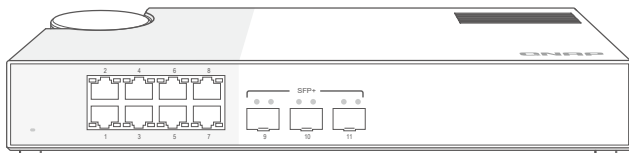
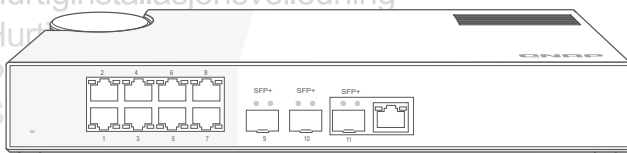



## Package Contents

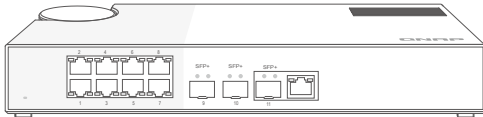

QSW-308-1C

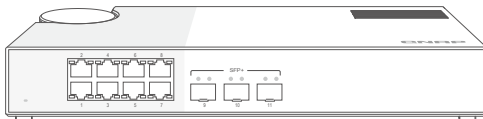

QSW-308S

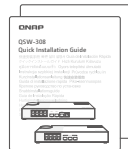
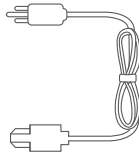
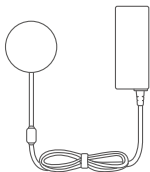

QIG

## Front Panel Ports

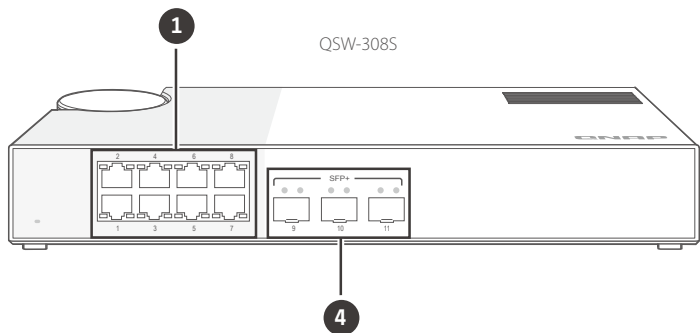
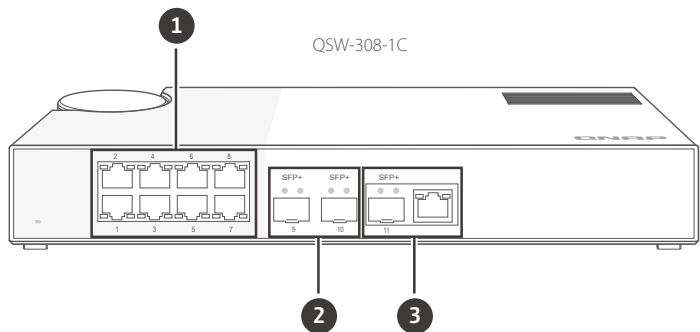

**1** 1GbE RJ45

**3** 10GbE SFP+/RJ45 Combo

**2** 10GbE SFP+

**4** 10GbE SFP+

## Front Panel LEDs

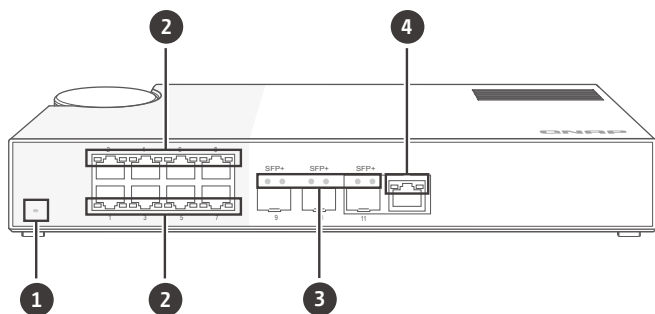

- 1 System Status
- 2 RJ45
- 3 SFP+
- 4 SFP+/RJ45 Combo

## LED Behavior

LED	Status	Description
System Status	Green	Device is powered on.
	Off	Device is powered off.
RJ45	Green (Left)	Link is operating at 1 Gbps.
	Amber (Right)	Link is operating at 100/10 Mbps.
	Flashing	Network is active.
	Off	No link.
SFP+	Green	Link is operating at 10/1 Gbps.
	Flashing	Network is active.
	Off	No link.
SFP+/RJ45 Combo	Green (SFP+)	Link is operating at 10/1 Gbps.
	Green (RJ45)	Link is operating at 10 Gbps.
	Amber (RJ45)	Link is operating at 5Gbps/2.5Gbps/1Gbps/100Mbps.
	Flashing	Network is active.
	Off	No link.

## Top Panel

### Power Input

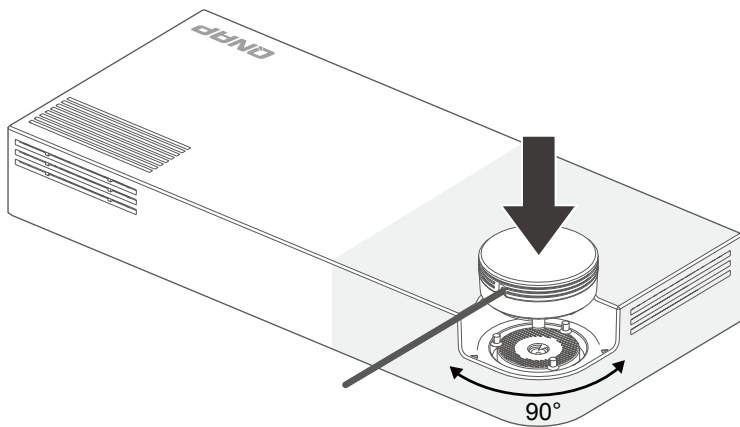

# Hardware Installation

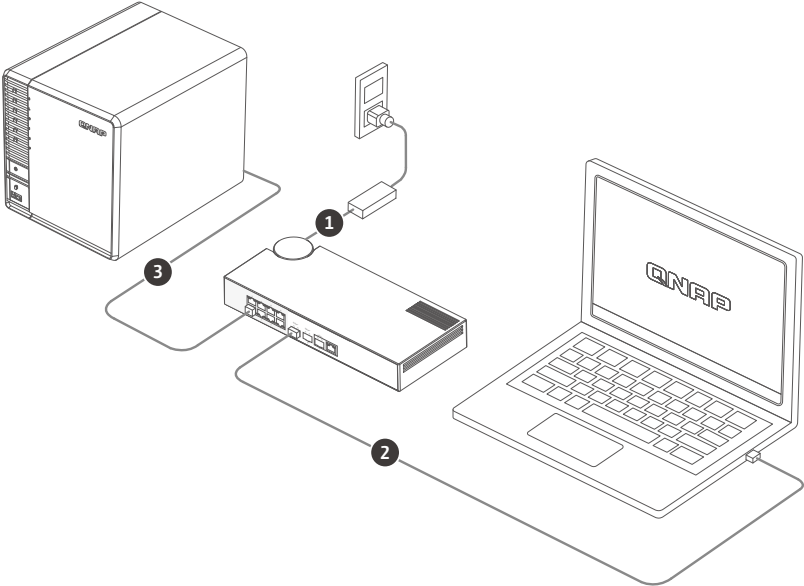
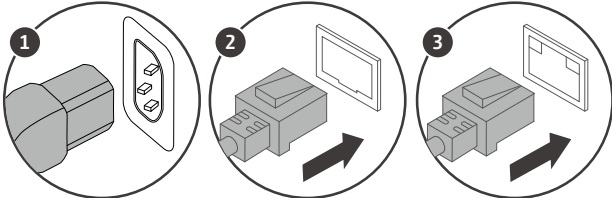

## Specifications

Model	QSW-308-1C	QSW-308S
Dimensions (H x W x D)	42.5 x 290 x 127 mm	
Net weight	0.77 kg	0.74 kg
Input voltage range	100 – 240VAC	
Switching capacity	76 Gbps	
Gigabit RJ45 ports	8	
10GbE SFP+ ports	2	3
Combo ports (SFP+/RJ45)	1	N/A
Operating temperature	0°C to 40°C (32°F to 104°F)	
Relative humidity	5% to 95% (non-condensing)	



This device complies with Part 15 of the FCC Rules. Operation is subject to the following two conditions:

1. This device may not cause harmful interference.
2. This device must accept any interference received, including interference that may cause undesired operation.

**FCC Class B Notice:**

This equipment has been tested and found to comply with the limits for a Class B digital device, pursuant to Part 15 of the FCC Rules. These limits are designed to provide reasonable protection against harmful interference in a residential installation. This equipment generates, uses, and can radiate radio frequency energy and, if not installed and used in accordance with the instructions, may cause harmful interference to radio communications. However, there is no guarantee that interference will not occur in a particular installation. If this equipment does cause harmful interference to radio or television reception, which can be determined by turning the equipment off and on, the user is encouraged to try to correct the interference by one or more of the following measures:

- Reorient or relocate the receiving antenna.
- Increase the separation between the equipment and receiver.
- Connect the equipment into an outlet on a circuit different from that to which the receiver is connected.
- Consult the dealer or an experienced radio/television technician for help.

**Modifications:**

Any modifications made to this device that are not approved by QNAP Systems, Inc. may void the authority granted to the user by the FCC to operate this equipment.



This QNAP NAS complies with CE Compliance Class B.



According to the requirement of the WEEE legislation the following user information is provided to customers for all branded QNAP products subject to the WEEE directive.

This symbol on the product or on its packaging indicates that this product must not be disposed of with your other household waste. Instead, it is your responsibility to dispose of your waste equipment by handing it over to a designated collection point for the recycling of waste electrical and electronic equipment. The separate collection and recycling of your waste equipment at the time of disposal will help to conserve natural resources and ensure that it is recycled in a manner that protects human health and the environment. For more information about where you can drop off your waste equipment for recycling, please contact your local city office, your household waste disposal service or the shop where you purchased the product.



更多關於安全、法規・與環境法令遵循相關的資訊・請參閱以下網址 [www.qnap.com/regulatory/](http://www.qnap.com/regulatory/)。



※付属の電源コードは当該製品専用です。他の機器に使用しないでください。

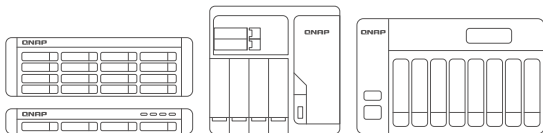

---

---

---

---

---

---

---

---

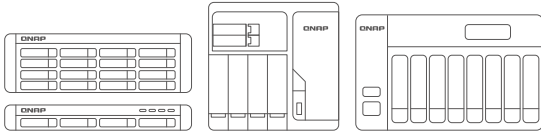

---

---

---

---

---

---

---

---

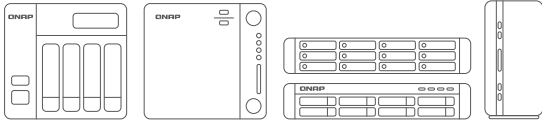

---

---

---

---

---

---

---

---



[install.qnap.com](http://install.qnap.com)



[helpdesk.qnap.com](http://helpdesk.qnap.com)



[docs.qnap.com](http://docs.qnap.com)

**QNAP**

Printed in Taiwan  
P/N: 51000-024714-RS